

DISCOVER OUR EVENT SPACES & FACILITIES

Scale Space White City

58 Wood Lane, London, W12 7RZ

A partnership between:



Imperial College
London



CONTENTS

Event Spaces	03
The Stadium	04
The Pitch	07
The Collaboration Room	09
The Terrace	10
Recording Facilities	11
Recording Space	12
Pod Space	13
Sport Space	14
Meeting Rooms	16
Hospitality	19



**WATCH A 60-SECOND
SHOWREEL OF OUR
EVENT SPACES**



Welcome to
SCALE SPACE

The scaleup community for
innovative businesses



Welcome to
SCALE SPACE

The scaleup community for
innovative businesses



EVENT SPACES

THE STADIUM

Capacity: 120

Best for: large events, in-person or hybrid. Can be configured as one larger room or two smaller spaces

Tech:

- Hybrid meeting capability
- Two camera systems: audience and presenter view
- Two integrated audio solutions with lapel and handheld microphones and ceiling-hanging microphones, alongside integrated speakers
- Room lighting with multiple channels for scene-setting
- In-room screen sharing
- On-site IT support available
- Video recording, live streaming and editing options available

Additional Options:

- Event catering

*25% Scale Space member discount. Half day (5hr) and full day (10hr) bookings reflect an additional discount on the hourly rate

	Half Room		Full Room	
	Non-member rates	Member rates*	Non-member rates	Member rates*
Hourly	£220	£165	£380	£285
Half Day	£860	£660	£1520	£1140
Full Day	£1505	£1155	£2660	£1995



THE STADIUM: ILLUSTRATIVE **FULL ROOM** CONFIGURATIONS

1 - CLASS ROOM

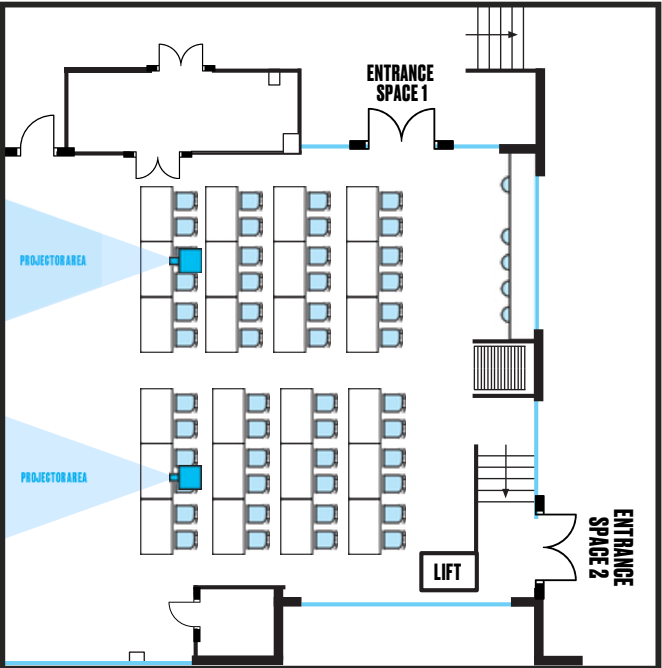

2 - FULL THEATRE

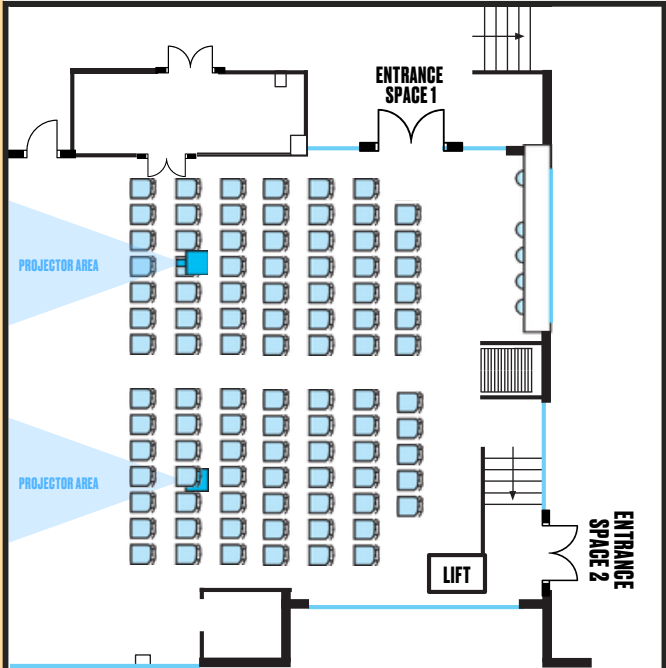

3 - CABARET

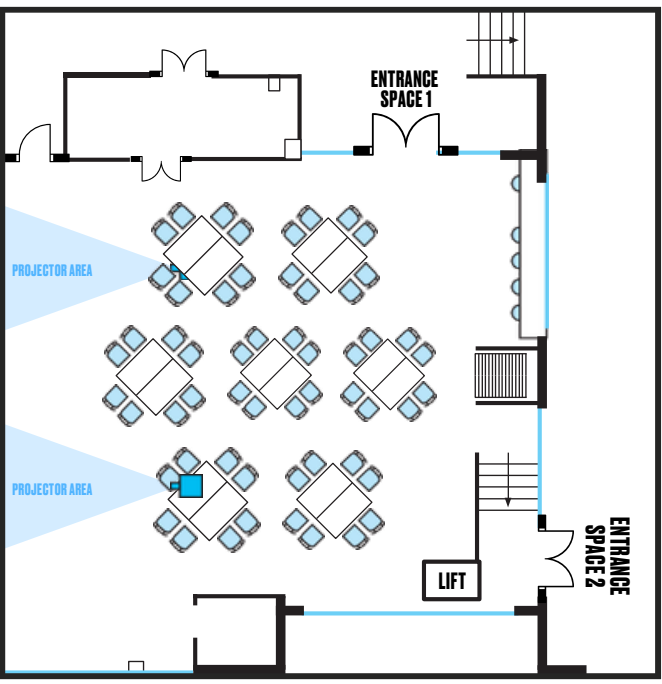

4 - BOARD MEETING

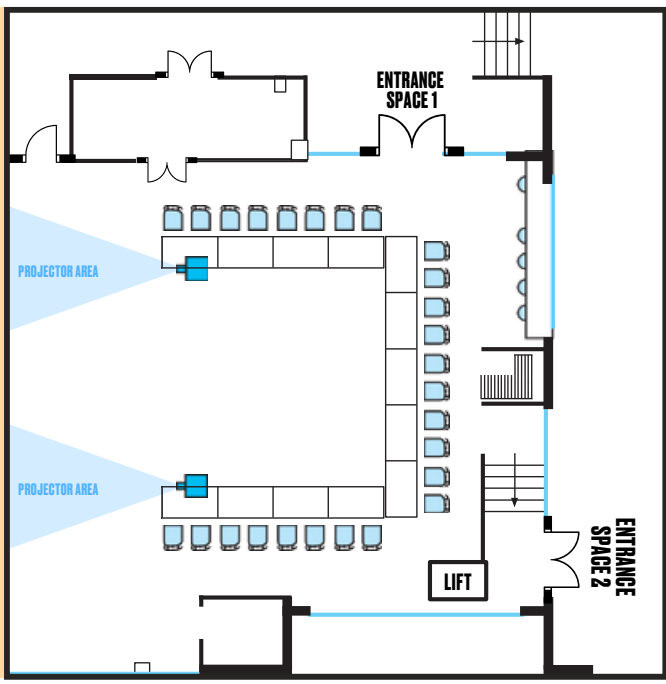

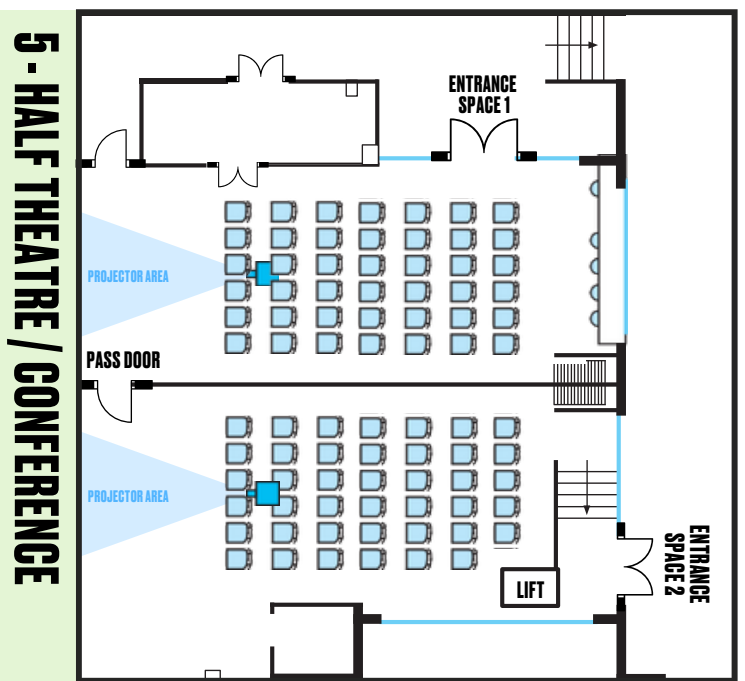
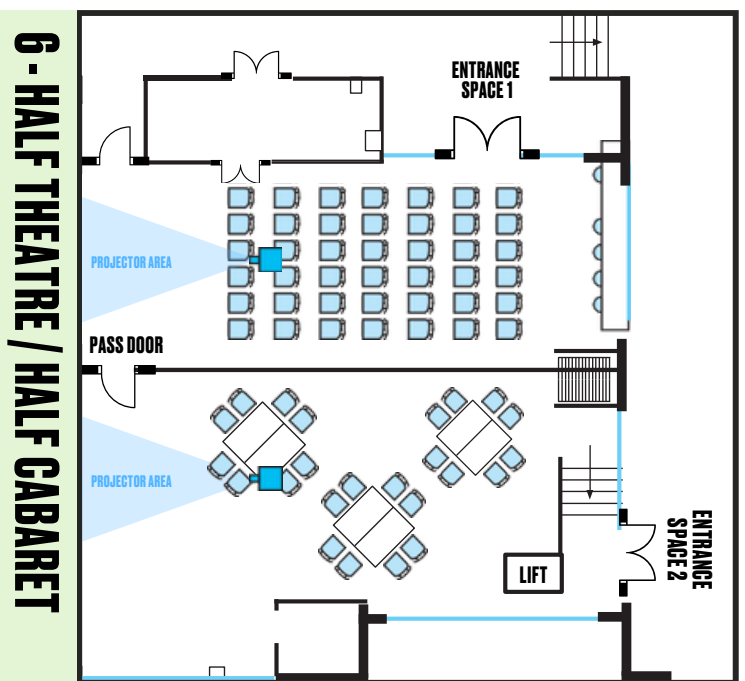
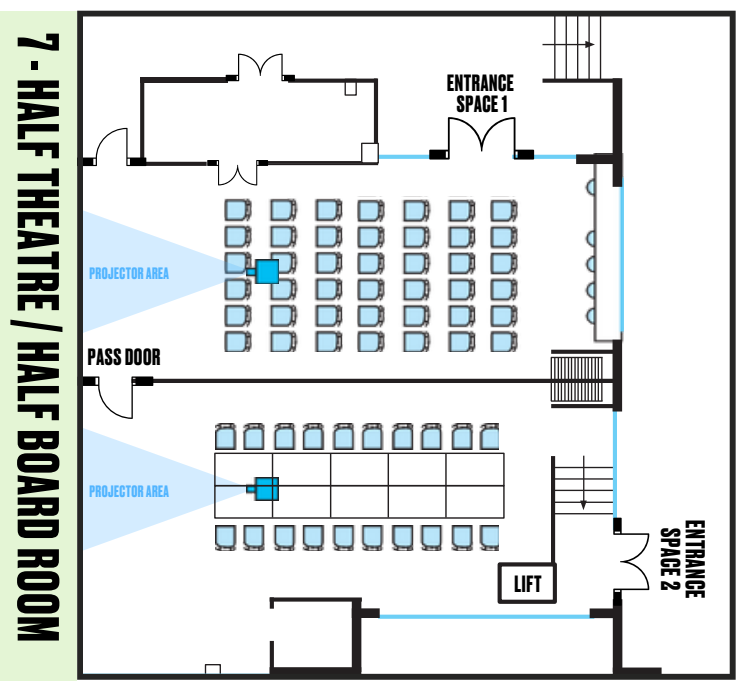

THE PITCH

Best for: townhall presentations, smaller team gatherings and formal stand-ups

Tech:

- 109" videowall with hybrid meeting capability
- Integrated speakers and microphone
- Two camera systems: audience and presenter view
- In-room screen sharing
- On-site IT support available

Additional Options:

- Event catering

*25% Scale Space member discount. Half day (5hr) and full day (10hr) bookings reflect an additional discount on the hourly rate

	Non-member rates	Member rates*
Hourly	£180	£135
Half Day	£720	£540
Full Day	£1260	£945

Capacity: 35





THE COLLABORATION ROOM

Capacity: 30

Best for: large strategy sessions bringing together remote and in-person teams. It enables 32 interactions simultaneously, allowing teams to present, collaborate and brainstorm seamlessly

LONDON'S FIRST 190" 6K PRYSM SCREEN

Event type:

- Immersive presentations and demos
- Multi-mode learning hub
- Ideation and team strategy sessions
- Multimedia product launches or board meetings
- Hybrid collaboration meetings across up to 25 sites
- Specialist video conferencing / greenscreen streaming

Tech:

- The tech in this room comes fully supported by a technician from Interaction.Works
- 190" 6K interactive multi-window presentation wall with integrated Zoom, Teams & WebEx
- Wall-to-wall whiteboarding
- Greenscreen live-streaming with handwriting extraction and presenter auto-tracking

*Non-supported rates apply for use as a standard in-person or hybrid meeting space without dedicated technician

	Member rates	Non-supported rates*
Hourly	£220	£135
Half Day	£880	£540
Full Day	£1540	£945



SEE THE
COLLABORATION
ROOM IN ACTION



THE TERRACE

Capacity: 70

Best for: corporate social functions, private catered events or high-end board meetings

Tech:

- Hybrid meeting capability
- Ceiling microphones and integrated speakers
- In-room screen sharing
- On-site IT support available

Additional Options:

- High-end event catering
- Private evening entertainment
- Client entertaining

*Member-only space. Minimum booking of half-day (5hrs)

	Member rates*
Half Day	£1050
Full Day	£1850





RECORDING FACILITIES



RECORDING SPACE

Best for: broadcast-quality recorded presentations, panel discussions or corporate videos

Event type:

- Podcasts
- Private recordings
- Webinars
- Interviews
- Panel discussions
- Virtual presentations

Additional Options:

- Pre- and post-production editing
- Social media soundbites

*This space is available to book fully supported or non-supported by dedicated technician.

	Supported room rates*	Non-supported room rates
Hourly	£250	£100
Half Day	£500	£400
Full Day	£1000	£800



**SEE
RECORDING
SPACE
IN ACTION**



POD SPACE

Best for: solo podcasts or recorded videos and soundbites. A quiet room for your next important meeting, webinar or presentation

Tech:

- Logitech Meet camera
- 4K Ultra HD video calling
- Logitech c920 webcam
- Soft lights
- Professional Blue Yeti microphone (USB)
- Logitech Zone headset
- Acoustic Panelling
- Green screen

Member rates

Hourly

£40



**SEE POD SPACE
IN ACTION**





SPORT SPACE



SPORT SPACE

Best for: sporting events, tournaments and team-building activities

Available for:

- Football
- Netball
- Cage Cricket
- Basketball (shoot-out only; no booking required)
- Fitness classes

Additional Options:

- Outdoor event catering and BBQ's

	Member rates
Hourly	£50
Half Day	£200
Full Day	£350



WORMWOOD

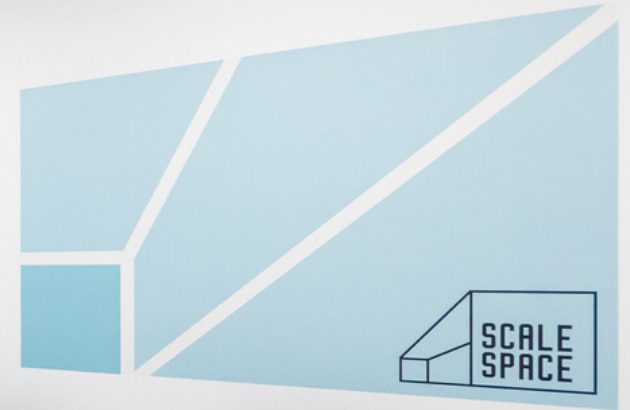

MEETING ROOMS



MEETING ROOMS

Room Features
<ul style="list-style-type: none"> • AV set up for hybrid meetings, available for both Mac and Windows • Whiteboard with markers • On-site IT support available • Furnivall: Exclusive for use with Microsoft Teams
Additional Options
<ul style="list-style-type: none"> • In-room catering • Paper flipcharts available on request



Room Name	Capacity	Hourly Rate
Lillie	3	£15
Roxwell	4	£30
Baker	4	£30
Willow	4	£30
Paddenswick	4	£30
Westcott	6	£36
Poplar	6	£36
Ariel	7	£42
Furnivall	7	£42
Blythe	7	£42
Dimco	8	£45
Craven	8	£45
Wormwood	8	£45
Longley	8	£45
Findon	10	£57
Loftus	12	£67
Avonmore	12	£67
Training Room	24	£120

SUMMARY

Room type	Room name	Capacity	High-spec TV screen	In-built PC	In-built cameras and microphones	Customised set-up	Best for:			
							Hybrid meetings	Team/client presentations	Workshop /team building	Recording video/audio
Meeting Room	(Multiple)	3-24	✓		✓		✓			
	Furnivall	7	✓	✓	✓		✓			
Event Space	The Stadium	120	✓		✓	✓	✓	✓	✓	
	The Pitch	35	✓	✓	✓	✓	✓	✓	✓	
	The Collaboration Room	30	✓	✓	✓	✓	✓	✓	✓	✓
	The Terrace	70	✓		✓	✓	✓	✓	✓	
Recording Facility	Recording Space	4			✓	✓				✓
	Pod Space	1			✓					✓
Other	Sport Space	50							✓	

HOSPITALITY

Provided by our in-house catering team, we can provide a number of menu options to suit your requirements.
Tea, coffee and biscuits are available at £2.50 per person



Working lunches – from £11.95pp



Grazing Platters – from £14.90pp



Finger Food – from £19.95pp



Bowl Food – from £3.95 per bowl



Breakfast – from £2.50pp



Note: 48 hours' notice required for all menus.

SEE YOU SOON!

For general questions about our
meeting rooms:

SUPPORT@SCALESPACE.CO.UK

If you would like to book any of
our event spaces:

EVENTS@SCALESPACE.CO.UK

